

36 MANDARA PLACE LONDON, SE8 5ET

£2,250 PCM

Offered unfurnished, this spacious two double bedroom apartment is ideal for a small family or for sharers and is located in the desirable new build Greenland Place development. The property is located perfectly for a short walk to Canada Water underground station and Surrey Quays for quick commute to Canary Wharf and the City. The property comprises of a spacious living space with stylish tiled floors throughout, two large double bedrooms, modern family bathroom, open plan kitchen with high gloss units and integral appliances leading to a generous lounge and balcony.

DouglasPryce

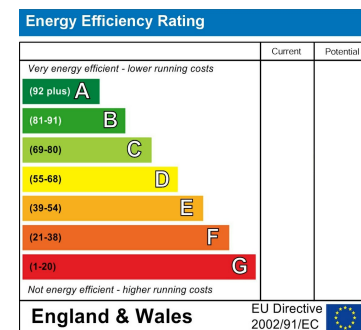
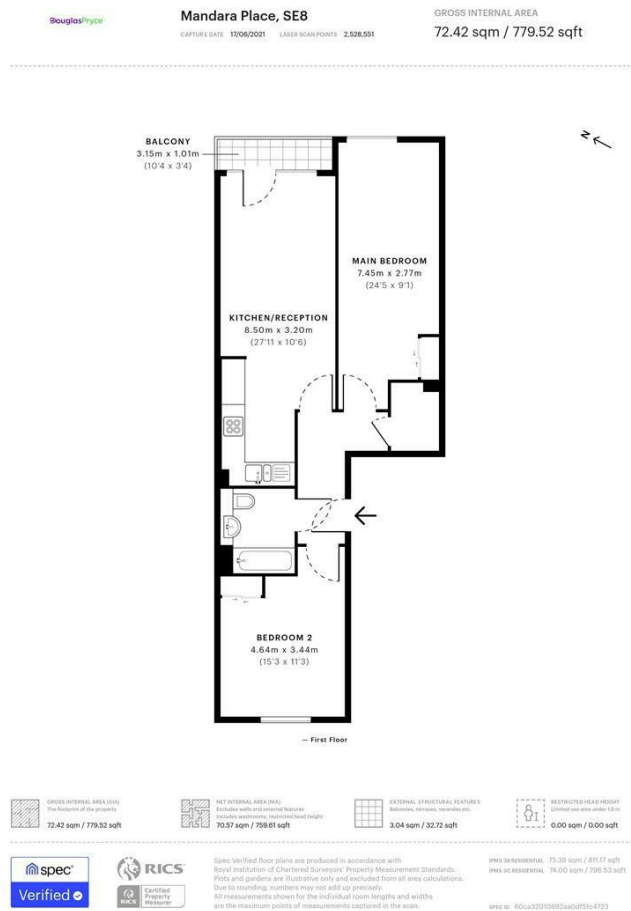

Agents Note: Whilst every care has been taken to prepare these particulars, they are for guidance purposes only. All measurements are approximate and are for general guidance purposes only and whilst every care has been taken to ensure their accuracy, they should not be relied upon and potential buyers/tenants are advised to recheck the measurements

Lettings
Verdant Lane
London
SE6 1LF

07887933642
glenn@douglaspryce.co.uk
www.douglaspryce.co.uk

DouglasPryce